

MPU3675 Magnetic Pickup

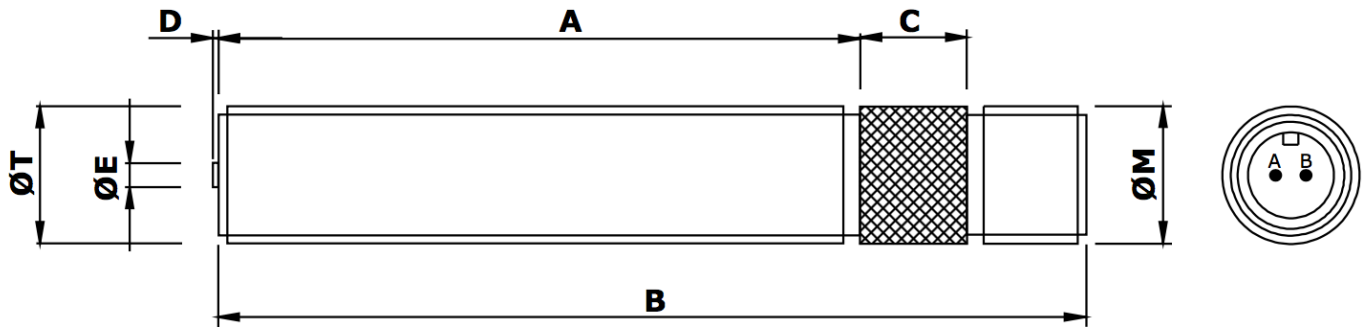

Mechanical specification

dimensions in mm unless otherwise stated

<i>Dimension</i>		<i>Part number</i>
A	75	
B	102	
C	12 medium diamond knurl	
D	0.6 nominal	
ØE	Ø2.8 Pole Piece	
ØM	5/8" x 24 tpi UNEF-2A (connector thread)	
ØT	5/8" x 18 tpi UNF-2A (body thread)	MPU3675-I
or	M16 x 1.5 6g	MPU3675-M
Main body material	Stainless Steel	
End Bobbin face	Polypropylene	
Locknut	1 off supplied as standard	

mpu3675 full v1.2 01/2020

Electrical specification

Resistance 250 ohms nominal @ 20°C

Inductance 60mH nominal

Operating temperature range -54°C to + 120°C

Voltage output 25V peak-peak [see note 1]

Minimum speed 22mm/second [see note 2]

Termination MS screw 10SL-4P (2-way integral plug)

Mating connector
[see note 3] MS screw 10SL-4S (2-way line socket)

Notes:

1. Nominal output is a typical peak to peak voltage measured across a 10K load using a 60 tooth mild steel gear wheel of Ø6", rotating at 1000 rpm and with an air gap setting of 0.01".
2. Minimum speed in mm/second to generate 100mV peak to peak typical output under standard test conditions as in note 1.
3. Mating line connectors (straight or 90°, complete with cable bush & clamp) are available to order separately.

Reliability, Guaranteed



Logitech Electronics Limited

MADE IN THE UK

mpu3675 full v1.2 01/2020