

# MPU36102 Magnetic Pickup

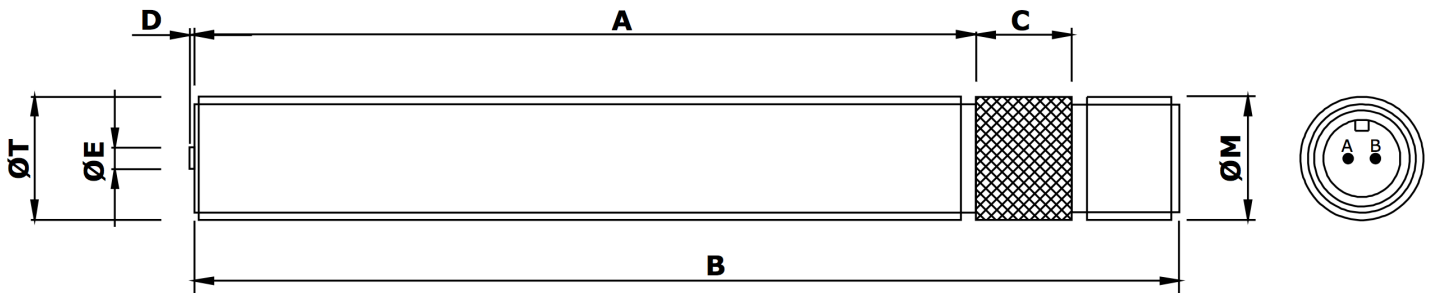

## Mechanical specification

dimensions in mm unless otherwise stated

Dimension	Part number	
A	102	
B	128	
C	12 medium diamond knurl	
D	0.6 nominal	
ØE	Ø2.8 Pole Piece	
ØM	5/8" x 24 tpi UNEF-2A (connector thread)	
ØT	5/8" x 18 tpi UNF-2A (body thread)	MPU36102-I
or	M16 x 1.5 6g	MPU36102-M
Main body material	Stainless Steel	
End Bobbin face	Polypropylene	

Locknut 1 off supplied as standard

mpu36102 full v1.2 01/2020

## Electrical specification

**Resistance** 250Ω nominal @ 20°C

**Inductance** 60mH nominal

**Operating temperature range** -54°C to +120°C

**Voltage output** 25V peak-peak [see note 1]

**Minimum speed** 22mm/second [see note 2]

**Termination** MS (screw) 10SL4P (2-pin integral plug)

**Mating connector**  
[see note 3] MS (screw) 10SL4S (2-pin line socket)

### Notes:

1. Nominal output is a typical peak to peak voltage measured across a 10K load using a 60 tooth mild steel gear wheel of Ø6", rotating at 1000 rpm and with an air gap setting of 0.01".
2. Minimum speed in mm/second to generate 100mV peak to peak typical output under standard test conditions as in note 1.
3. Mating line connectors (straight or 90°, complete with cable bush & clamp) are available to order separately.

*Reliability, Guaranteed*



**Logitech Electronics Limited**

**MADE IN THE UK**

mpu36102 full v1.2 01/2020

**SENSORMATIC**  
SPECIALIST & SOLUTIONS

Sensormatic srl - Via della Beverara 13 - 40131 Bologna - Italia  
Tel. +39 051 63 53 511 - [smbox@sensormatic.it](mailto:smbox@sensormatic.it) - [www.sensormatic.it](http://www.sensormatic.it)