

MPU1665 Magnetic Pickup

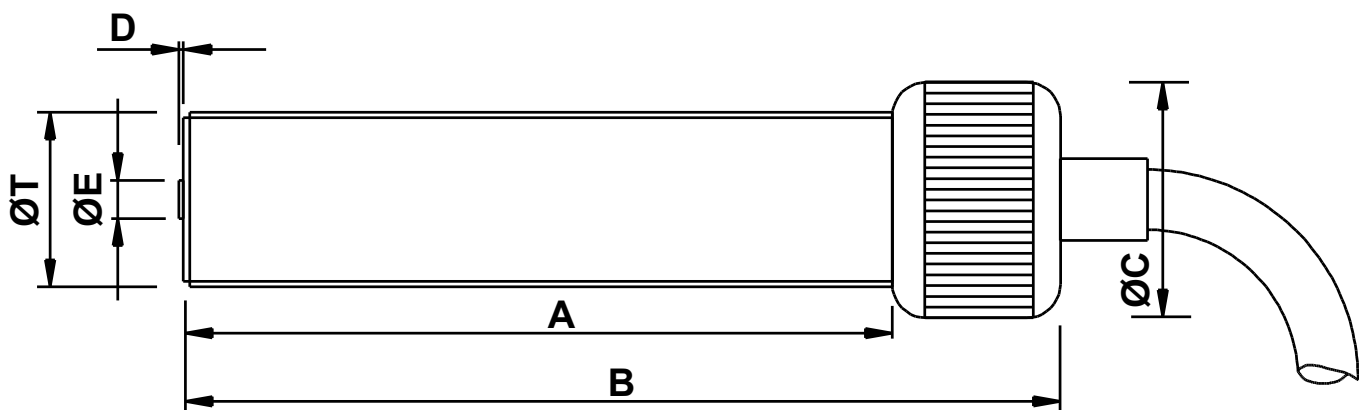

Mechanical specification

dimensions in mm unless otherwise stated

Dimension	Part number	
A	65	
B	82 nominal	
ØC	Ø22 medium straight knurled cap	
D	0.4 nominal	
ØE	Ø3.17 Pole Piece	
ØM	n/a	
ØT	5/8" x 18 tpi UNF-2A	MPU1665-I*
or	M16 x 1.5 6g	MPU1665-M*
Main body material	Stainless Steel	
End Bobbin face	Glass filled Nylon or Polypropylene	
Locknut	1 off supplied as standard	

mpu1665 full v1.2 01/2020

*Previous code MPU1163-I/2.5" / MPU1163-M/2.5"

Electrical specification

Resistance 350Ω nominal @ 20°C

Inductance 150mH nominal

Operating temperature range -10°C to +85°C

Voltage output 20V peak-peak [see note 1]

Minimum speed 30mm/second [see note 2]

Termination 2-core (7/0.2) screened cable x 2 metres

Notes:

1. Nominal output is a typical peak to peak voltage measured across a 10K load using a 60 tooth mild steel gear wheel of Ø6", rotating at 1000 rpm and with an air gap setting of 0.01".
2. Minimum speed in mm/second to generate 100mV peak to peak typical output under standard test conditions as in note 1.

Reliability, Guaranteed



Logitech Electronics Limited

MADE IN THE UK

mpu1665 full v1.2 01/2020

sensorMATIC
SPECIALIST&SOLUTIONS

Sensormatic srl - Via della Beverara 13 - 40131 Bologna - Italia
Tel. +39 051 63 53 511 - smbx@sensormatic.it - www.sensormatic.it