



# ALU-FLEX

## ALUMINIUM GROOVED FLEXIBLE COUPLINGS OR STAINLESS STEEL

- Without free-plays. They do not produce any speed variations in the transmission
- High torsional rigidity
- Available with setscrews and built-in clamps
- Resistant to oils and chemical products
- Mechanical protection against excessive torque



ALU-FLEX are single flexible couplings in a single piece, machined from hardened aluminium alloy. They are suitable for transmissions that require moderate torque and when shaft misalignment is not very large. They act as mechanical fuses to excessive torques.

These couplings are suitable for measurement and control systems, together with reduced torque drives. They permit transmission of very precise kinematic movement, without free-

play and with low torsional elasticity. They are recommended for auxiliary machines, tachometric generators potentiometers and encoders etc.

The coupling will absorb errors in alignment and shaft installation.

### TECHNICAL SPECIFICATIONS

	Torque <i>Ncm</i>	Clamping torque <i>Ncm</i>	Max. Speed <i>rpm</i>	Admissible max. misalignment			Torsion spring stiffness <i>Nm/rad</i>	Radial spring stiffness <i>N/mm</i>	Weight <i>gr</i>	Inertia <i>gcm<sup>2</sup></i>
				Angular	Axial	Radial				
				<i>degree</i>	<i>mm</i>	<i>mm</i>				
<b>AFP 6508</b>	2	8	8.000	±2	±0,15	±0,1	0,55	24	0,5	0,02
<b>AFP 1015</b>	15	15	8.000	±2	±0,2	±0,15	2,2	22	2,4	0,34
<b>AFP 1218</b>	25	35	8.000	±2,5	±0,25	±0,15	2,8	28	4	0,83
<b>AFP 1622</b>	40	80	8.000	±3	±0,3	±0,2	5	34	9,5	3,2
<b>AFP 1922</b>	60	80	8.000	±3,5	±0,4	±0,25	9	40	13	6,7
<b>AFP 2524</b>	100	120	8.000	±4	±0,5	±0,3	20	60	26	22,2
<b>AFP 2532</b>	100	120	8.000	±4	±0,5	±0,3	18	50	35	30
<b>AFP 3030</b>	150	120	8.000	±4	±0,5	±0,3	21	60	45	57
<b>AFP 3038</b>	150	120	8.000	±4	±0,5	±0,3	21	60	60	76
<b>AFA 1421</b>	50	50	6.000	±3	±0,25	±0,2	4,5	22	6,5	1,9
<b>AFA 1625</b>	60	50	6.000	±3,5	±0,3	±0,2	5,5	30	10	3,8
<b>AFA 1928</b>	80	120	6.000	±4	±0,4	±0,25	8	36	16	8,7
<b>AFA 2532</b>	100	100	6.000	±4	±0,5	±0,35	16	45	34	29
<b>IFA 2532</b>	200	150	6.000	±4	±0,5	±0,35	29	150	88	84
<b>AFA 3038</b>	150	100	6.000	±4	±0,5	±0,35	19	60	58	76

# ALU-FLEX

## ALUMINIUM GROOVED FLEXIBLE COUPLINGS OR STAINLESS STEEL

### AFP 6508 - Aluminium

Ordering code example: AFP 6508 02/02

Ø d1/d2

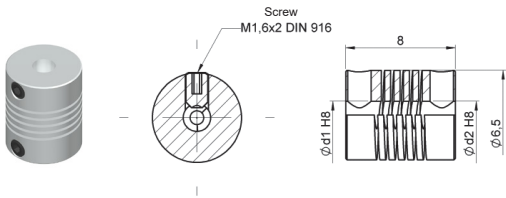

01/01  
01/02  
02/02

### AFP 1015 - Aluminium

Ordering code example: AFP 1015 02/02

Ø d1/d2

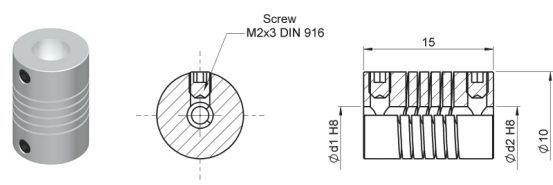

02/02  
02/03  
02/04  
02/05  
03/03  
03/05

### AFP 1218 - Aluminium

Ordering code example: AFP 1218 04/04

Ø d1/d2

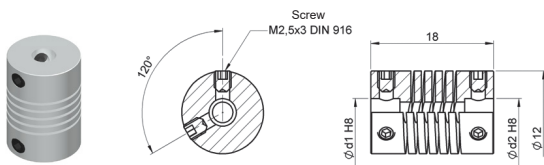

02/04  
03/03  
03/04  
04/04

### AFP 1622 - Aluminium

Ordering code example: AFP 1622 06/06

Ø d1/d2

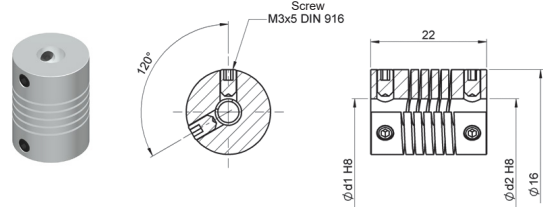

03/03  
04/04  
04/05  
05/05  
06/06

### AFP 1922 - Aluminium

Ordering code example: AFP 1922 06/06

Ø d1/d2

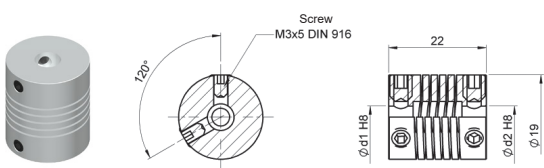

04/06  
05/05  
06/06

### AFP 2524 - Aluminium

Ordering code example: AFP 2524 06/06

Ø d1/d2

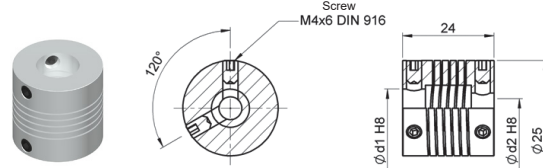

06/06  
06/08  
06/10  
08/08  
10/10  
12/12

### AFP 2532 - Aluminium

Ordering code example: AFP 2532 10/10

Ø d1/d2

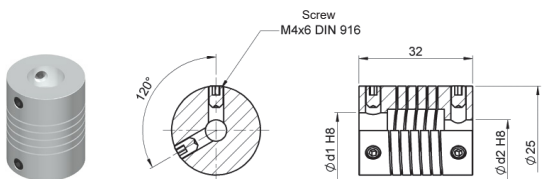

06/06  
06/08  
08/08  
08/10  
10/10  
10/12

### AFP 3030 - Aluminium

Ordering code example: AFP 3030 10/10

Ø d1/d2

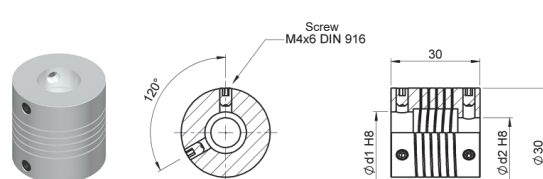

10/10  
10/12  
10/14

### AFP 3038 - Aluminium

Ordering code example: AFP 3038 12/12

Ø d1/d2

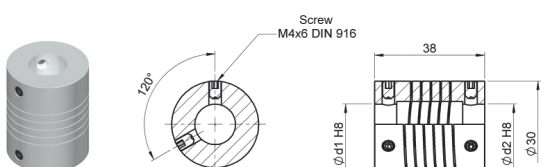

10/10  
12/12  
14/14

### AFA 1421 - Aluminium

Ordering code example: AFA 1421 04/04

Ø d1/d2

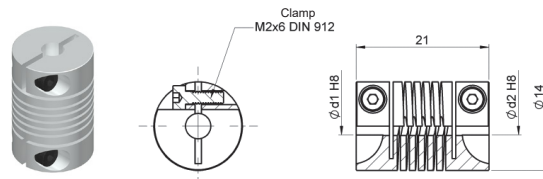

02/02  
02/03  
03/03  
03/04  
04/04

# ALU-FLEX

## ALUMINIUM GROOVED FLEXIBLE COUPLINGS OR STAINLESS STEEL

### AFA 1625 - Aluminium

Ordering code example: AFA 1625 05/05

Ø d1/d2

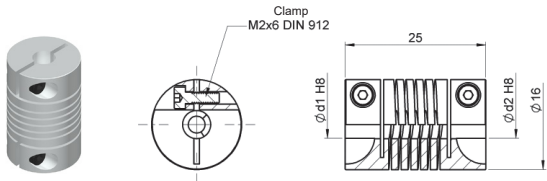

03/03  
03/05  
04/04  
05/05

### AFA 1928 - Aluminium

Ordering code example: AFA 1928 06/06

Ø d1/d2

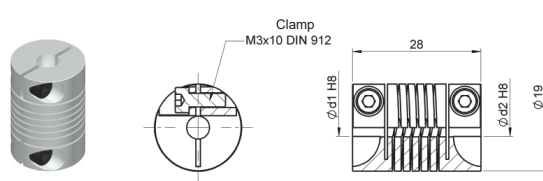

04/04  
04/06  
05/05  
05/06  
06/06

### AFA 2532 - Aluminium

Ordering code example: AFA 2532 10/10

Ø d1/d2

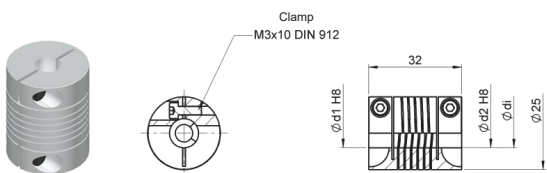

06/06  
06/08  
06/10  
08/08  
08/10  
10/10  
10/12

### IFA 2532 - Stainless Steel

Ordering code example: IFA 2532 10/10

Ø d1/d2

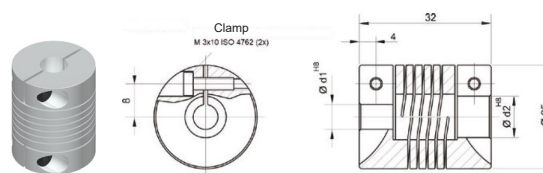

06/06  
06/08  
06/10  
08/08  
08/10  
10/10

### AFA 3038 - Aluminium

Ordering code example: AFA 3038 12/12

Ø d1/d2

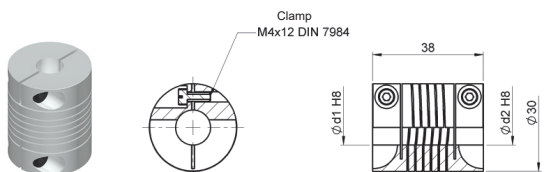

10/10  
12/12  
14/14