

Wall Mounting



Wall Mount Bracket
(Exposed wiring type)
NH-WST

Compatible products
NH-FB

Material: SECC



Mounting dimensions (Units:mm)

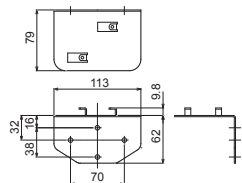

Wall Mount Bracket
(Exposed wiring type)
NH-WST2

Compatible products
NH-FV, LA6-POE

Material: SECC



Mounting dimensions (Units:mm)

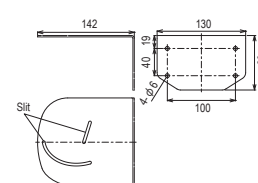

For T-type Aluminum Pole



L-bracket
SZL-001

Compatible products
LR Series

Corresponding pole
POLE22-AT

Material: SPHC-P



Mounting dimensions
(Units:mm)

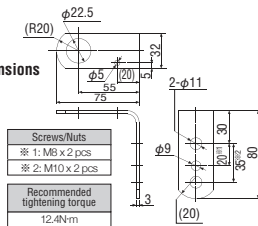

For N-type Aluminum Pole



Circular Multi-mount Bracket
SZP-001W/U/K

Compatible products
LR series

Corresponding pole
POLE22-AN

Material: PC



Mounting dimensions
(Units:mm)

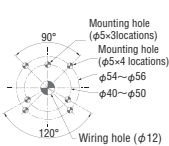

Circular Bracket
SZP-002U

Compatible products
LR series

Corresponding pole
POLE22-AN

Material: ADC12



Mounting dimensions
(Units:mm)

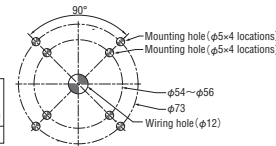

For N/T-type



Wall Mount Bracket
SZK-001U

Compatible products
LR series

Corresponding pole
POLE22-AN
POLE22-AT

Material: ADC12



Mounting dimensions
(Units:mm)

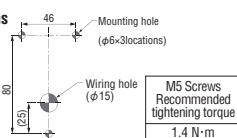

Circular Bracket
SZP-003W/U/K

Compatible products
LR series

Corresponding pole
POLE22-AN

Material: PC



Mounting dimensions
(Units:mm)

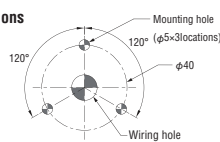

Folding Bracket
SZQ-001W

Compatible products
LR series

Corresponding pole
POLE22-AN

Material: PC



Mounting dimensions
(Units:mm)

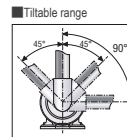
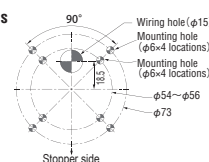

Pole Mounting



Upper Bracket
SZP-101

Compatible products
SKH / SF10 / SL10

Corresponding pole
POLE22-AN
POLE22-AT

Material: PC



Mounting dimensions
(Units:mm)

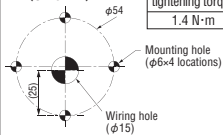

NPT Bracket
SZP-102

Compatible products
SKS / SF08 / SL08

Material: AL



NPT Bracket
SZP-103

Compatible products
SKH / SF10 / SL10

Material: AL



NPT Bracket
SZP-104

Compatible products
SKP / SL15

Material: AL



NPT Bracket
SZP-090U

Compatible products
LR4-WJ / LR5-WJ / LR5-WT / LR5-KT

Material: AL



NPT Bracket
SZP-091U

Compatible products
LR6-WJ / LR7-WJ / LR7-WT / LR7-KT

Material: AL



* Use mounting rubber gasket when installing 3-screw mounting type units. Bracket does not support AC cord with plug.

Poles and Pole Assemblies

70 mm

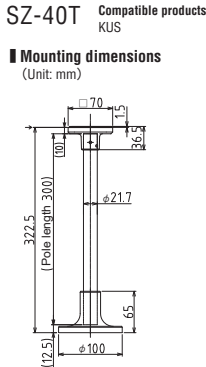
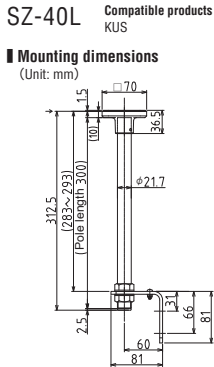

81 mm

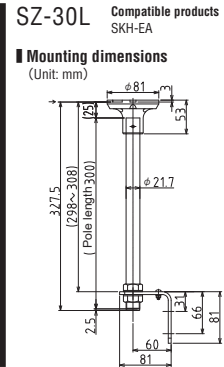

60 mm

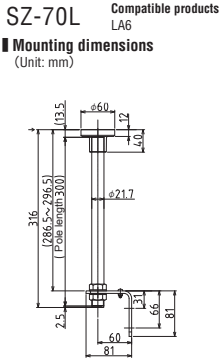

Steel Pole



- 22POLE-300** Compatible products LA6
 - 22POLE-500** Compatible products LA6
 - 22POLE-1000** Compatible products LA6
- Materials: carbon steel pipes for ordinary piping
- RoHS 10

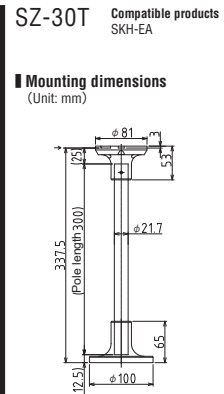

Aluminum Pole

(Bind tapping screw for affixing pole (2 screws) included)

*When cutting the poles, do not cut with pole cutters. Use a fret saw, power saw, or jigsaw.

*If changing from direct mounting specifications to pole mounting specifications, please purchase pole brackets together with the aluminum pole.

- | | | | |
|----------------|-------------------------------|---------------------|----------------------------|
| N type | 100mm Type: POLE22-0100AN(K) | T type | 100mm Type: POLE22-0100AT |
| | 300mm Type: POLE22-0300AN(K) | | 300mm Type: POLE22-0300AT |
| | 500mm* Type: POLE22-0500AN | Nut included | 500mm Type: POLE22-0500AT |
| NK type | 800mm* Type: POLE22-0800AN(K) | | 800mm Type: POLE22-0800AT |
| | 1000mm* Type: POLE22-1000AN | | 1000mm Type: POLE22-1000AT |

*Compatible brackets: SZK-001U, SZP-002U, SZ-010. *We accommodate pole lengths other than the above as custom orders. Compatible pole lengths: 150mm, 200mm, 250mm, 350mm, 400mm, 450mm, 600mm, 700mm, 900mm

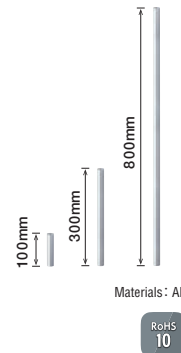

POLE-800A21+00109

Compatible products SZP-004W

POLE-300A21+00109

Compatible products SZP-004W

POLE-100A21+00109

Compatible products SZP-004W

NPT Adaptor

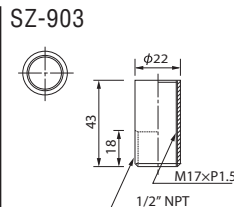
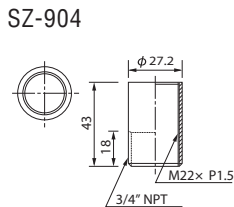

Pole Bracket

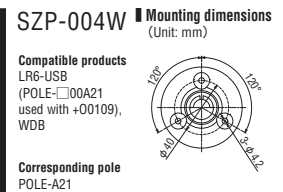
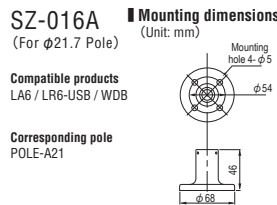
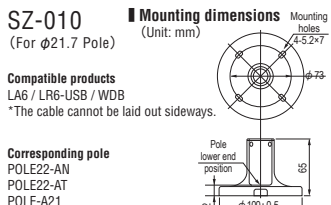

Platform Bracket



SZ-100 (Off-white)
SZ-100D (Dark Gray)
SZ-100S (Silver paint)

Compatible products
LS7

Material: Heat-resistant ABS
RoHS 10

Mounting dimensions
(Unit: mm)

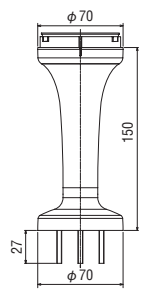

Pole Bracket



Material: PC
RoHS 10

NE-001D

Compatible products
NE-A / NE-IL

Corresponding pole
POLE22-AN (excluding NE-IL)
POLE22-AT (excluding NE-IL)
POLE-A21

Multi-mount Bracket



SZ-130 SZ-130S SZ-130D
Material: PC

SZ-130

Compatible products
LS7

RoHS 10

Partition Mounting Bracket



NH-PST

Compatible products
NH-FB

Material: SECC

RoHS 10

Desktop Platform



SZW-060W

Compatible products
LA6-SDTNWB-POE,
LA6-5AWJWB-RYGB

RoHS 10

Rack Mounting Bracket



NBM-ANG

Compatible products
NBM

Material: SECC

RoHS 10

Ceiling Mounting Bracket



SZW-101

Compatible products
SKH/SF10/SL10

Material: SPCE

RoHS 10



RF-002

Compatible products
RFV/RFT

*It cannot be used in a place
exposed to water.

Material: ABS

RoHS 10

Mounting dimensions
(Unit: mm)

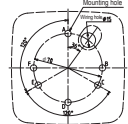

*If screwing in 2 locations, use A-D and B-F; if mounting in 3 locations, use A-C-E. Please mount with M6 screws.

Rubber Gasket



SZW-102

Compatible products
SKS / SF08 / SL08
3-point bolt foot mounting type

Material: Silicon

RoHS 10



SZW-103

Compatible products
SKH/SF10/SL10
3-point bolt foot mounting type

Material: Silicon

RoHS 10

WD System Setup Kit



WDX-6LRB

Compatible products
WDT-6LR-Z2

RoHS 10



WDX-5LRB

Compatible products
WDT-5LR-Z2

RoHS 10



WDX-SC01

Approximately 3 m long.

Compatible products
WDB

RoHS 10

Serial Cable

WD System Setup Software



WDS-WIN01

Compatible products
WDR-Z2-PRO / WDR-Z2

* Free version is limited to
changing the transmitter and
receiver settings. Data collection
only available with paid license.

Tint Film



NHL-TF

Compatible products
NHL-FV2 / NHL-FB2

NHP-TF

Compatible products
NHP-FV2 / NHP-FB2 / PHE-3FB3

RoHS 10

Universal AC Adapter



ADP-001

Compatible products
NH / NBM-D88N / PHE-3FB3
PHC-D08 / WDR-LE-Z2
WDX-5LRB / WDX-6LRB
WDR-LE-Z2-PRO(-L)

Compatible countries
Japan, Europe, U.S., China, Korea,
Taiwan, Thailand, Indonesia, Canada,
Philippines, Vietnam

RoHS 10



RoHS 10

Connector with cable
(OMRON model)

SZ-120-02 (2m)
(XS2F-D821-DH0-R)

SZ-120-05 (5m)
(XS2F-D821-GH0-R)

SZ-120-10 (10m)
(XS2F-D821-JH0-R)

Compatible products
LS7, LR6-WC

Mounting Bracket for LED Work Light



SZ-310AR
Rear attachment screw mount (2 included)



SZ-310ARM
Rear attachment magnetic mount (2 included)

Mounting dimensions
(Unit: mm)

25
2-Magnet (SZ-310 ARM Only)
3-Φ4.2(countersink)

Compatible products
CLA-A

Material: PC

RoHS 10



Materials:
Cold rolled stainless steel plate (SUS304)

SZ-320KS

Compatible products
CLK / CLK-A / CWK

Mounting dimensions
(Unit: mm)

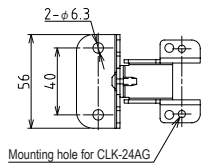

RoHS 10



SZ-310AS
Rear attachment screw mount. (2 included)

Compatible products
CLA-A

Material: PC

Mounting dimensions
(Unit: mm)

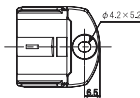

RoHS 10



Material:
Cold rolled stainless steel plate (SUS304)

CLK-001

Compatible products
CLK / CLK-A

Mounting dimensions
(Unit: mm)

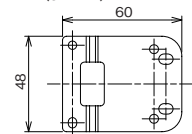

RoHS 10



SZ-310ASB Rear attachment screw mount.
Compatible with CLB-24N. (2 included)

Compatible products
CLA-A

Material: PC

Mounting dimensions
(Unit: mm)

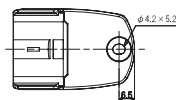

RoHS 10



Material: SUS304

CWF-001
Swivel Bracket

Compatible products
CWF

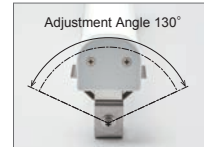

※Accessory Bracket Screw 2pcs included.
Mounting screws not included.

RoHS 10



SZ-310EU
Rear mounting stainless steel bracket, silver

Compatible products
CLA-A

Material: Stainless Steel

Mounting dimensions
(Unit: mm)

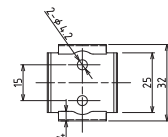

RoHS 10



Material: Neodymium Magnet

CWF-002
Magnetic Mounting Bracket

Compatible products
CWF

RoHS 10

※Accessory Bracket Screw 2pcs included